

New product

RA Series

Recessed architectural battery unit



Construction

- Thermoplastic rectangular fixture with additional round trim-plate, white finish
- All-metal backbox enclosure
- Optional black finish
- Fixed optics, optimized light distribution for ceiling heights up to 12 ft
- Four high-intensity LEDs with redundant connections; 140 lm/W, CCT 5000K

Options

- Standard unit 680 lumens
- Square distribution unit 717 lumens
- Plenum-rated enclosure
- Fixed, square distribution pattern up to 12 ft. ceilings

Mounting

- Easily spring mounted in sheetrock ceilings
- Recessed installation in t-bar suspended ceilings

Photometry performance

The **RA Series** has a fixed lighting distribution, optimized by design for ceiling heights up to 12 ft. The **RA Series** delivers a stable and optimal illumination easy to specify. Along an office corridor the space coverage ranges from 68 to 80 feet. The square distribution pattern covers a surface of more than 700 square feet.

Table A: Standard unit 6-ft wide corridor¹

Mounting height	Lumens	Spacing center-to-center
9 ft		68 ft
10 ft	680	80 ft
12 ft		72 ft

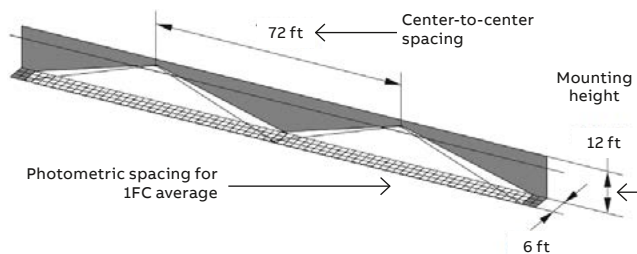

Housing color



Electronics

- Infrared remote test control (up to 30ft)
- Self-test and diagnostic functions optional
- Two-wire universal AC input: 120 – 277VAC 50-60 Hz
- Battery full recharge in 24 hours
- 90 minutes of emergency lighting
- Optional time delay: 15 minutes
- Optional Nexus®Pro IOT emergency lighting central monitoring system
- Optional Power over Ethernet (requires a dedicated PoE switch supplied by an unswitched AC line)

Battery

- High temperature rated lithium battery

Approvals

- Listed UL-924 for damp locations: 50° to 104°F (10° to 40°C)
- NSF listed for splash/non-food zone applications
- BC - California Energy Commission Title 20

Warranty

- Unit has a five year limited warranty
- Detailed warranty terms located online at: www.emerigi-lite.com/usa/files/el_warranty.pdf



Remote test control



Power consumption and unit rating

AC	Input (VAC)	Maximum			Standby power (W)
		Current (A)	Power (W)	Power factor	
	120	0.03	2.8	0.6	0.5
	277	0.02		0.5	
POE	DC supply (V)		Maximum		
			Current (A)	Power (W)	
	44-57		0.08	3	

Table B: Option "square distribution pattern" – single unit coverage¹

Mounting height	Lumens	Room size	Room surface
10 ft	717	27 ft x 27 ft	729 square feet

¹Note: Illumination levels as per the Life Safety Code (NFPA 101): Average 1 fc, Minimum 0.1 fc, Max-to-min ratio 40:1. Typical reflectance levels of walls/ceiling/floor: 80/50/20.

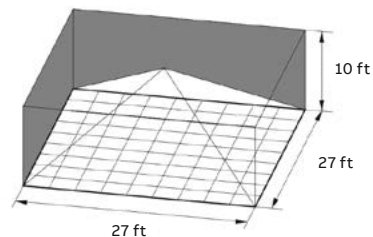

Dimensions

Dimensions are approximate and subject to change.

Recessed suspended ceiling mount

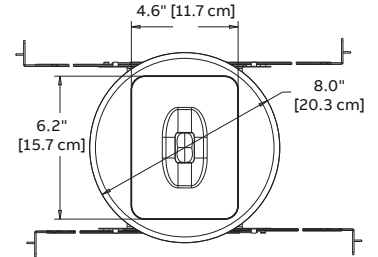
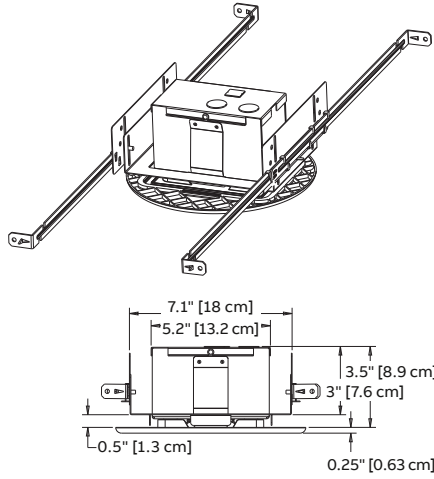
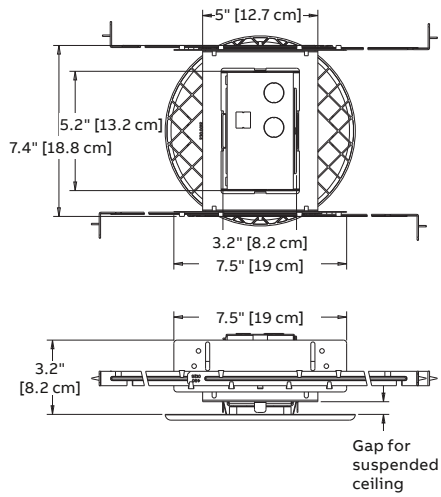

Recessed sheetrock ceiling mount

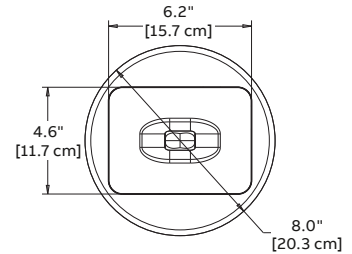
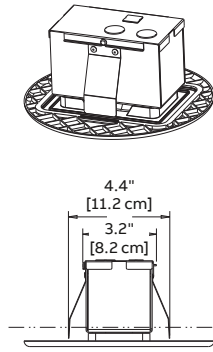
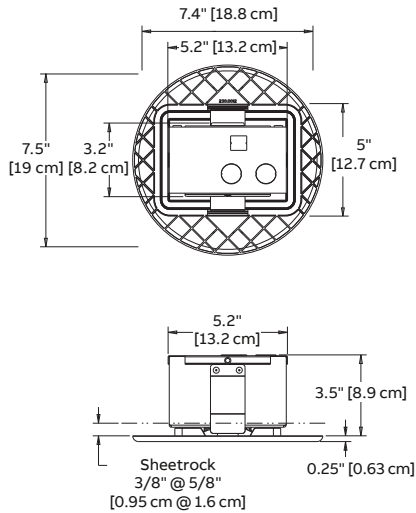

How to order

Color	Series	Input voltage	Unit type	Options
B= Black W= Factory white	RA= Recessed architectural	Blank= 120 to 277VAC, 50/60Hz POE= power over ethernet	Blank= standard charger D= Advanced Diagnostics, non-audible NEXP= Nexus®Pro IoT	Blank= no options D3= 15 minute time delay P= plenum/type IC rated SQ= Square distribution pattern

Example: WRAPOEDD3