

TS Series

Designed for unobtrusive use in T-bar ceilings



Housing

- Steel housing
- Standard off-white finish, optional black finish
- Lighting heads, available in thermoplastic or decorative die-cast aluminum
- Choice of MR16 LED lamp wattages

Mounting

- Fully recessed ceiling
- Hanger bars included for lay-in installation in t-bar grid

Electronics

- Pulse plus charger
- Low voltage disconnect
- Automatic brownout protection
- Battery lock-out
- Fused output circuit
- Optional Advanced Diagnostics
- Optional Nexus® monitoring system
- 120/277 60Hz

Choice of sealed maintenance-free battery

- 6V or 12V lead-calcium battery
- 12V nickel-cadmium battery

Approvals

- UL 924 listed
- NYC approved

Warranty

- Unit has a five-year limited warranty
- Detailed warranty terms located on page 202 or online at:
www.emergi-lite.com/usa/files/EL_Warranty.pdf

Photometry performance

Lamp	Spacing center-to-center (feet)	
	7' mounting height	15' mounting height
LA	43'	36'
LB	81'	64'
LG	55'	43'
LI	71'	56'
LJ	100'	85'

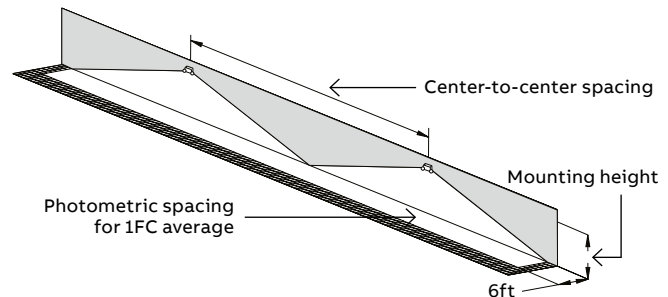

Dimensions

Dimensions are approximate and subject to change.

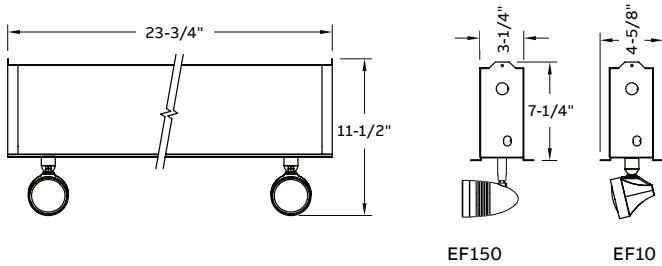

Unit rating

Sealed maintenance-free battery types	DC voltage	Model number	Battery capacity in watts			
			1 1/2 hrs	2 hrs	3 hrs	4 hrs
Lead-calcium	6	TSM18	18	12	10	7
	12	12TSM36	36	25	20	14
Nickel-cadmium	12	12TSC50	50	36	25	18

Accessories (order as a separate item)

Description	Suffix
Remote test switch (metal face plate)	RTS
Remote test switch (plastic face plate)	RTS-1

How to order

Series	Series/battery type/capacity	# of heads	Head style	Lamp type/wattage	Options
Blank=	Lead-calcium	-0= No head	10= EF10 mini	LA= 6V-4W,	-AD= Advanced Diagnostics
Factory white	TSM18= 6V-18W lead-calcium	-2= Two heads	plastic MR16	MR16 LED	(audible) ¹
B= Black enclosure	12TSM36= 12V-36W lead-calcium		150= EF150 heads MR16	LB= 6V-5W, MR16 LED	-ADNA= Advanced Diagnostics (non-audible) ¹
	Nickel-cadmium			LG= 12V-4W, MR16 LED	-D3= Time delay (15 minutes) ²
	12TSC50= 12V-50W nickel-cadmium			LI= 12V-5W, MR16 LED	-NEX= Nexus® wired (consult your sales representative)
				LJ= 12V-6W, MR16 LED	-NEXRF= Nexus® wireless (consult your sales representative)

Example: BRSM18-210LA-AD

¹Minimum lamp load required: 20% of unit capacity.

²Time delay available with AD or ADNA models only.