

## TS Series

Designed for unobtrusive use in T-bar ceilings



### Housing

- Steel housing
- Standard off-white finish, optional black finish
- Lighting heads, available in thermoplastic or decorative die-cast aluminum
- Choice of MR16 LED lamp wattages

### Mounting

- Fully recessed ceiling
- Hanger bars included for lay-in installation in t-bar grid

### Electronics

- Pulse plus charger
- Low voltage disconnect
- Automatic brownout protection
- Battery lock-out
- Fused output circuit
- Optional Advanced Diagnostics
- Optional Nexus® monitoring system
- 120/277 60Hz

### Choice of sealed maintenance-free battery

- 6V, 12 or 24V lead-calcium battery
- 6V, 12 or 24V nickel-cadmium battery

### Approvals

- UL 924 listed
- NYC approved

### Warranty

- Unit has a five-year limited warranty
- Detailed warranty terms located on page 178 or online at:  
[www.emergi-lite.com/usa/files/EL\\_Warranty.pdf](http://www.emergi-lite.com/usa/files/EL_Warranty.pdf)

### Photometry performance

Lamp	Spacing center-to-center (feet)	
	7' mounting height	15' mounting height
LA	43'	36'
LG	55'	43'
LI	71'	56'
LJ	100'	85'
LL	56'	44'

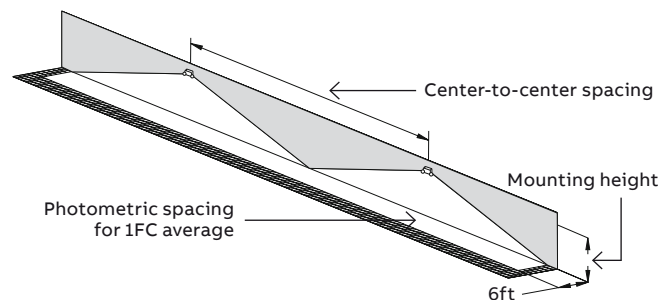

**Dimensions**

Dimensions are approximate and subject to change.

**Cabinet information**

Cabinet size	Dimensions	
	A	B
S	3-1/4"	4-5/8"
L	5-5/8"	7-1/8"

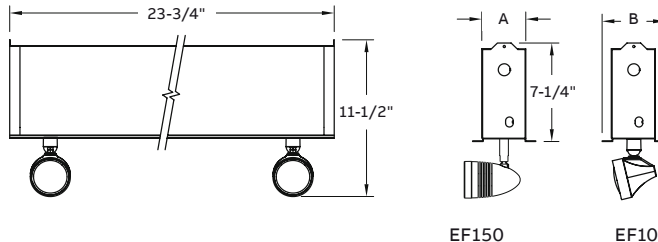

**Unit rating**

Sealed maintenance-free battery types	DC voltage	Model number	Battery capacity in watts				Cabinet size
			1 1/2 hrs	2 hrs	3 hrs	4 hrs	
Lead-calcium	6	TSM18	18	12	10	7	S
	6	TSM27	27	18	14	10	S
	6	TSM36	36	25	20	14	S
	6	TSM54	54	37	28	21	S
	6	TSM81	81	54	42	30	L
	6	TSM110	110	72	56	40	L
	12	12TSM36	36	25	20	14	S
	12	12TSM54	54	37	28	21	S
	12	12TSM110	110	72	56	40	L
	24	24TSM110	110	72	56	40	L
Nickel-cadmium	6	TSC18	18	12	9	6	S
	6	TSC25	25	18	12	9	S
	12	12TSC36	36	21	15	12	S
	12	12TSC50	50	36	25	18	S
	24	24TSC100	100	73	50	37	L

**Accessories** (order as a separate item)

Description	Suffix
Remote test switch (metal face plate)	RTS
Remote test switch (plastic face plate)	RTS-1

**How to order**

Series	Series/battery type/capacity	# of heads	Head style	Lamp type/wattage	Options
Blank= Factory white enclosure B= Black enclosure	<b>Lead-calcium</b>	-0= No head	10= EF10 mini plastic MR16	LA= 6V-4W, MR16 LED	-AD= Advanced Diagnostics (audible) <sup>1</sup>
	TSM18= 6V-18W lead-calcium	-1= One head	150= EF150	LG= 12V-4W, MR16 LED	-ADNA= Advanced Diagnostics (non-audible) <sup>1</sup>
	TSM27= 6V-27W lead -calcium	-2= Two heads		LI= 12V-5W, MR16 LED	-D3= Time delay (15 minutes)
	TSM36= 6V-36W lead-calcium	-3= Three heads		LJ= 12V-6W, MR16 LED	-NEX= Nexus® wired (consult your sales representative)
	TSM54= 6V-54W lead-calcium			LL= 24V-4W, MR16 LED	-NEXRF= Nexus® wireless (consult your sales representative)
	TSM81= 6V-81W lead-calcium				
	TSM110= 6V-110W lead-calcium				
	12TSM36= 12V-36W lead-calcium				
	12TSM54= 12V-54W lead-calcium				
	12TSM110= 12V-110W lead-calcium				
	24TSM110= 24V-110W lead-calcium				
	<b>Nickel-cadmium</b>				
	TSC18= 6V-18W nickel-cadmium				
	TSC25= 6V-25W nickel-cadmium				
	12TSC36= 12V-36W nickel-cadmium				
12TSC50= 12V-50W nickel-cadmium					
24TSC100= 24V-100W nickel-cadmium					

Example: BRSC18-210LA-AD

<sup>1</sup>Minimum lamp load required: 20% of unit capacity. Not available with 100W Ni-Cd 24V.