



TYPE: \_\_\_\_\_  
 CATALOG #: \_\_\_\_\_  
 NOTES: \_\_\_\_\_

# Chicago Prestige™

## Edge-Lit Series

### Premium white LED Exit Signs

### Features

- Housing: Die-Cast aluminum back box, trim ring, trim plate and canopy. Standard finish is brushed aluminum with other finishes available as an option
- Face Plate: Virgin acrylic face plate is thin, silk-screened to provide a flawless legend. Face plates are available with red letters on a white background
- White LED light source, 10-year life expectancy
- Sealed Maintenance-Free Batteries Nickel-Cadmium (providing minimum 2-hour illumination) in emergency lighting mode
- Self-Diagnostic is optional for all Self-Powered units
- Reliability: The Chicago Prestige™ Series has a 5-year full warranty
- Power requirements: 120-277VAC, 60Hz
- Transfer: solid state relay automatically and instantly transfers lamp load upon failure of AC supply
- Brownout: close tolerance electronic circuit activates emergency unit when utility power dips below nominal voltage
- Charger: current limited and short circuit proof. The equipment is capable of full recharge in compliance with UL 924 specifications
- Controls: Combination of push button test switch and LED AC indicator light
- All mounting configurations use the same basic components. Inserting a trim ring allows for recessed mounting on walls or ceilings. Applying a canopy allows for surface mounting on ceilings or walls as back or end mount.
- UL924 Listing
- City of Chicago Approved
- 5 Year Full warranty

Detailed warranty terms located at: [www.emergi-lite.com/usa/files/EL\\_Warranty.pdf](http://www.emergi-lite.com/usa/files/EL_Warranty.pdf)

### Accessories (order as a separate item)

DESCRIPTION	SUFFIX
White Pendant	P*_WT
Black Pendant	P*_BK
Gray Pendant	P*_GY

\* Custom pendant lengths and colors available specify (12", 24", 36", etc.)

### Backbox (order as a separate item)

DESCRIPTION	SUFFIX
Backbox Kit white	BBKTS-WT-E
Backbox Kit black	BBKTS-BK-E
Backbox kit brushed aluminum	BBKTS-BA-E
Backbox kit chrome	BBKTS-CH-E
Backbox kit dark bronze	BBKTS-BR-E
Backbox kit polished brass	BBKTS-PB-E

### Arrow (Chevron) Designation

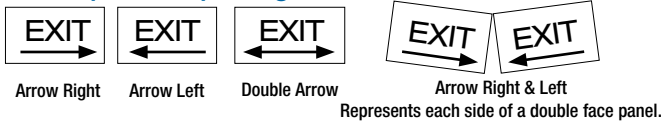

\*Wording and chevrons not to scale. For illustration purposes only.

### Dimensions

Dimensions are approximate and subject to change.

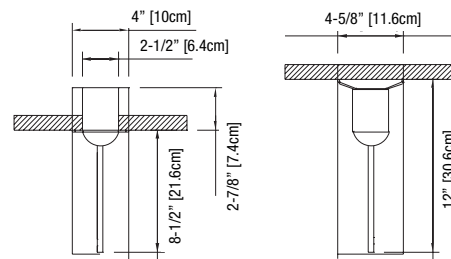
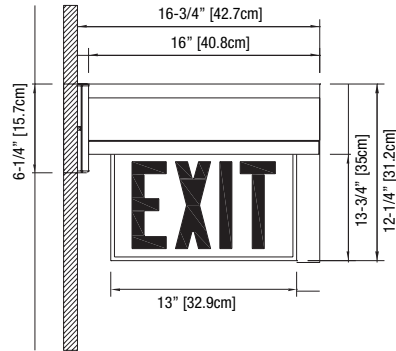
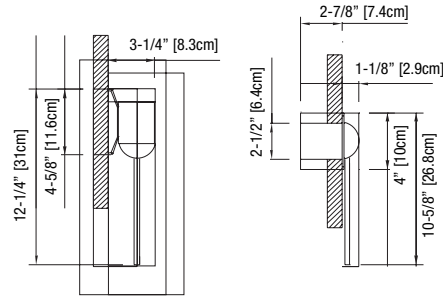

\*Add 1-1/2" to height of unit when ordering panel with arrow

TYPE: \_\_\_\_\_  
 CATALOG #: \_\_\_\_\_  
 NOTES: \_\_\_\_\_



# Chicago Prestige™ Edge-Lit Series Premium white LED Exit Signs

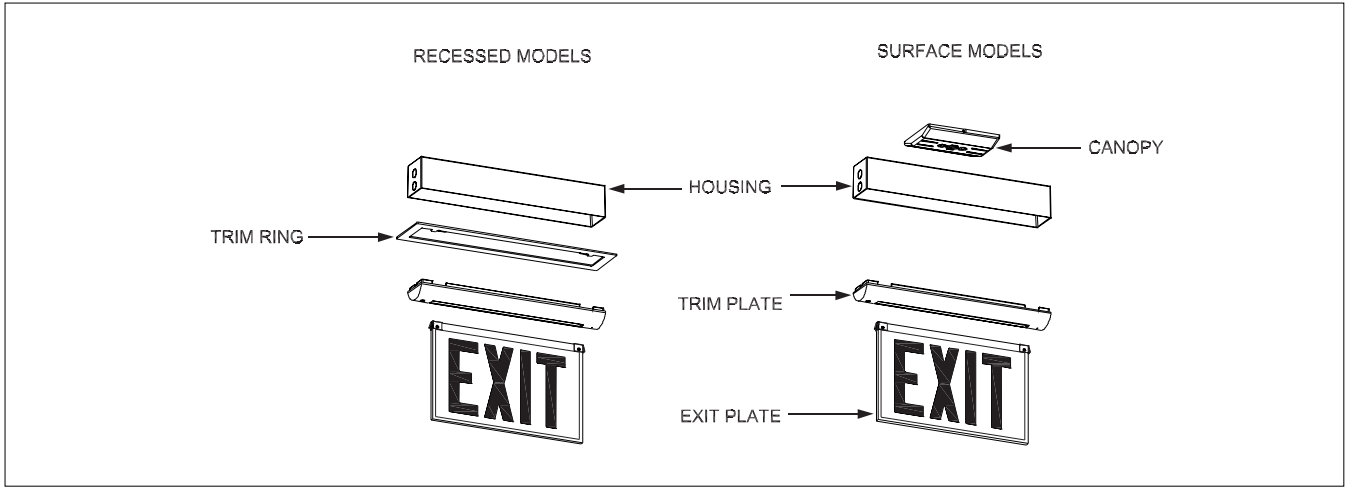

### Power Consumption Chart

MODEL	AC SPECS		DC SPECS	
AC-only	120 to 277VAC	Less than 2.5W	-	-
AC/DC-remote	120 to 277VAC	Less than 2.5W	6 to 24VDC	Less than 2.5W
Self-Powered	120 to 277VAC	Less than 3.5W	Ni-Cd battery	2 Hours
Self-Powered diagnostic	120 to 277VAC	Less than 3.5W	Ni-Cd battery	2 Hours

### How to Order

HOUSING COLOR	CUSTOM SPECIFICATION	MODEL	LEGEND AND PANEL	TRIM PLATE	OPTIONS
<b>Blank</b> = Brushed aluminum <b>W</b> = White <b>B</b> = Black <b>BR</b> = Dark bronze (painted) <b>PB</b> = Polished brass <b>CH</b> = Polished Chrome	<b>CC</b> = City of Chicago	<b>PLX</b> = AC only <b>PLXDC</b> = AC/DC-Remote 6-24V <b>PLX2CKT</b> = AC-Dual circuit <b>PLXN</b> = Self-Powered <b>PLXND</b> = Self-Powered Diagnostic	<b>#2A</b> = Single Face, STAIRS, No Arrow <b>#17A</b> = Double Face, STAIRS, No Arrow <b>#5A</b> = Single Face, STAIRS, Arrow right <b>#8A</b> = Single Face, STAIRS, Arrow left <b>#11A</b> = Single Face, STAIRS, Double Arrow <b>#23A</b> = Double Face, STAIRS, Double Arrow <b>#20A</b> = Double Face, (1) STAIRS, (2) STAIRS, Single Arrow <b>#3</b> = Single Face, EXIT, No Arrow <b>#18</b> = Double Face, EXIT, No Arrow <b>#6</b> = Single Face, EXIT, Arrow right <b>#9</b> = Single Face, EXIT, Arrow left <b>#12</b> = Single Face, EXIT, Double Arrow <b>#24</b> = Double Face, EXIT, Double Arrow <b>#21</b> = Double Face, (1) EXIT, (2) EXIT, Single Arrow <b>LP</b> = Panel shipped separately	<b>A</b> = Angular <b>C</b> = Circular	<b>-DL</b> = Damp Locations <b>-X</b> = Less backbox

Example: **WCCPLX#2AA**